



CATALOGUE 2017-2018

Bring Home Happiness

INDEX

Company Profile	1
LED Introduction	2-3
LED Lamp (Bulbs)	4-7
LED Panel	8-16
LED Clean Room Light	17
LED Spot Light	18-19
LED Tube Light	20-21
LED Linear Light	22
LED Weatherproof Fixture	23
LED Retrofit Lamps	24-25
LED Street Light	26-29
LED Flood Light	30
LED High Bay Light	31
LED Strip Light	32-33
LED Garden Light	34
LED Well Glass Light	35
Bollard Light	36
LED Up / Down Wall Light	37
CFL Lamps	38-41
Institutional Clients	42-43

Company Profile

Usha Shriram Enterprises is a multi-product company. It is one of the most trusted brands in India with its focus on innovation and technology. The company offers a gamut of products lines such as: Lighting, Appliances, Cookware, Water and Air Purifiers, Fans, Mobile Phones, Furniture, Luggage, CCTV Camera, TV & Mattresses and has even diversified into the Hotel Industry.

Usha Shriram's products marketed under various brands like USHA SHRIRAM Lighting, USHA SHRIRAM Cookware, USHA SHRIRAM Water and Air Purifiers, USHA SHRIRAM Mobiles, USHA EUROLEX LUGGAGE, EUROLEX Appliances and Fans, USHA SHRIRAM Furniture and USHA EUROLEX HOTELS are trusted for their quality and reliability.

Usha Shriram Enterprises has built its reputation over decades through its quality products and excellent services ensuring customer satisfaction. The company's products are also exported to countries in the Middle East and Africa are tested for all necessary India and International standards at its extensive and well equipped facility.

The company believes that its strength is its talented workforce who remain motivated to exceed customer expectations and create customer delight always. This, is what has made USHA, USHA SHRIRAM & EUROLEX a force to reckon with in the industry and has also given the brands phenomenal goodwill.

USHA LED Lights offers a wide range of International quality LED lighting solutions. The products ranging from residential to retail and commercial lighting provides effective and energy efficient solutions for multiple environments.

The seamless integration of USHA LED lights into the structure of the product / appliances allow for artistic freedom to the designers to give an edge to a conventional product.

WHAT IS AN 'LED' ?

LEDs, or Light Emitting Diodes, work when the movement from electrons illuminate the semiconductor materials. LED Technology, now in use for some time in traffic and highway signals in the new favorite over incandescent bulbs and CFLs in consumer lighting, thanks to the plethora of benefits it brings to the table.

BENEFITS OF 'LED' LIGHTS

- Longer Life
- Turns 'On' Instantly / Flicker Free Start
- Compact Size
- Directs Light More Efficiently
- No Infrared Or UV Emissions
- No Mercury Hazard - Environment Friendly
- Excellent Operating Voltage Range
- Very Low Heating - Cool To Touch
- Shock & Vibration Resistant



No UV/IR



No Mercury Hazard

COMPARISON OF BURNING LIFE

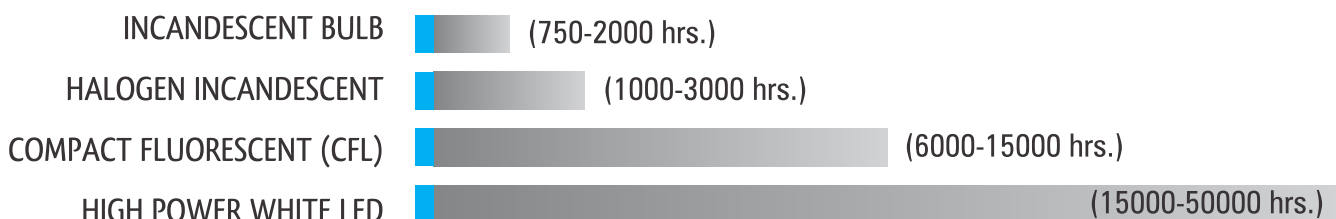

(Source : U.S. Dept. of Energy)

The USHA LED light range is very wide and consists of products both for domestic & commercial applications :

- LED BULBS
- LED TUBE LIGHTS
- LED DOWN LIGHTERS– SQUARE AND ROUND
- LED CEILING MOUNTED PANELS – SQUARE AND ROUND
- LED DOME LIGHTS
- LED COB LIGHTS
- LED STREET LIGHTS
- LED HIGH-BAY LIGHTS
- LED FLOOD LIGHTS
- LED 2X2 PANEL LIGHTS



LIGHTING IN HOMES

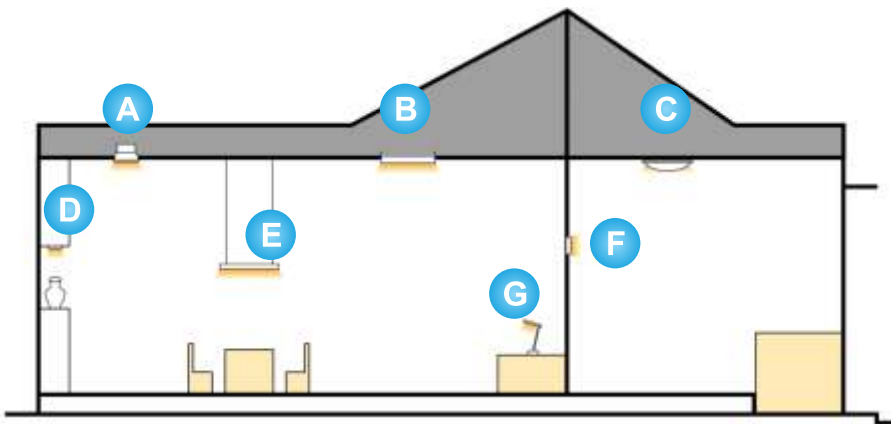

- A** DOWN LIGHT
- B** PANEL
- C** CEILING MOUNT
- D** SPOT LIGHT
- E** PANEL
- F** SMALL PANEL
- G** TABLE LAMP

LIGHTING IN OFFICES / COMMERCIAL PLACES

- A** PANEL
- B** DOWN LIGHT (NON-DIRECTION)
- C** DOWN LIGHT (DIRECTION)
- D** TUBE LIGHT

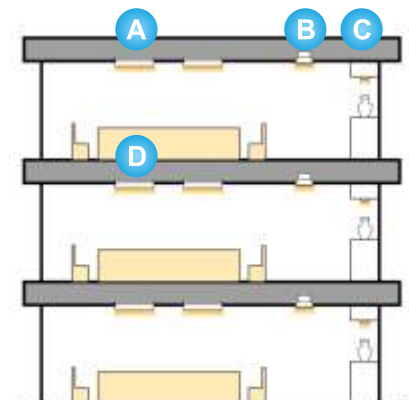



LED BULB : E-GLOW

MODEL NO.	WATTAGE	DIAMETER (MM)	LUMENS
LBB-503-AL	3 W	50	210
LBB-505-AL	5 W	57	400
LBB-507-AL	7 W	57	600
LBB-509-AL	9 W	57	750
LBB-512-AL	12 W	60	1200
LBB-514-AL	14 W	68	1400
LBB-518-AL	18 W	80	1800
LBB-523-AL	23 W	80	2300

SPECIFICATIONS

CCT	2700K/4000K/6500K
CRI	>80
Power Factor	>0.95
Input Voltage	110 - 290V
Ingress Protection	IP 20
Operating Temp.	-10°C to 55°C
Working Life	25000 Hours
Base	B - 22, E - 27
Beam Angle	>140°
Housing	Aluminium Diecast
Diffuser	Polycarbonate
Elegant & Traditional Looks	



APPLICATIONS

Showrooms • Malls • Houses • Offices •
Hospitals • Hotels • Restaurants • Rural
Areas



Eco
Friendly



Save
Energy



Instant
Start



No UV/IR



No Mercury
Hazard



Non
Dimmable



LED BULB : NEO

MODEL NO.	WATTAGE	DIAMETER (MM)	LUMENS
LBB-603-AL	3 W	50	210
LBB-605-AL	5 W	57	400
LBB-607-AL	7 W	57	600
LBB-609-AL	9 W	60	750
LBB-612-AL	12 W	68	1050
LBB-615-AL	15 W	68	1400
LBB-618-AL	18 W	80	1800

SPECIFICATIONS

CCT	2700K/4000K/6500K
CRI	> 80
Power Factor	> 0.95
Input Voltage	110 - 290V
Ingress Protection	IP 20
Operating Temp.	-10°C to 55°C
Working Life	25000 Hours
Base	B - 22, E - 27
Beam Angle	> 140°
Housing	Aluminium Diecast
Diffuser	Polycarbonate
Elegant & Traditional Looks	



APPLICATIONS

Showrooms • Offices • Malls • Homes •
Restaurants • Marts • Galleries



Eco
Friendly



Save
Energy



Instant
Start



No UV/IR



No Mercury
Hazard



Non
Dimmable



LED BULB : NEO

MODEL NO.	WATTAGE	LUMENS
LBB-626-AL	26 W	2500
LBB-636-AL	36 W	3450
LBB-645-AL	45 W	4300

SPECIFICATIONS

CCT	2700K/4000K/6500K
CRI	>80
Power Factor	>0.95
Input Voltage	110 - 290V
Ingress Protection	IP 20
Operating Temp.	-10°C to 55°C
Working Life	25000 Hours
Base	B - 22, E - 27
Beam Angle	>140°
Housing	Aluminium Diecast
Diffuser	Polycarbonate
Elegant & Modern Looks	



APPLICATIONS

Showrooms • Malls • Houses • Offices •
Hospitals • Hotels • Restaurants • Rural
Areas



Eco
Friendly



Save
Energy



Instant
Start



No UV/IR



No Mercury
Hazard



Non
Dimmable



LED NIGHT LAMP - SPARKLE

MODEL NO. : LNB-105

Available in 6 Colors:
White / Green / Blue /Red
Orange / Yellow

SPECIFICATIONS

Input Voltage	110 - 290V
Ingress Protection	IP 20
Operating Temp.	-10°C to 55°C
Working Life	25000 Hours
Base	B - 22
Beam Angle	120°

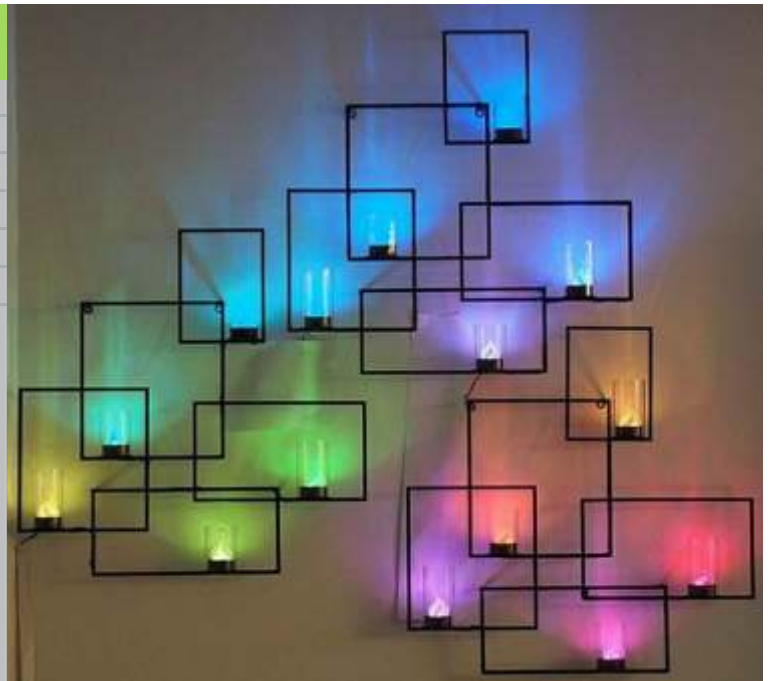

APPLICATIONS

Homes • Offices • Restaurants • Testing
Labs • Decorations



Eco
Friendly



Save
Energy



Instant
Start



No UV/IR



No Mercury
Hazard



Non
Dimmable



SLIM PANEL : STERRA - SL ROUND

MODEL NO.	WATTAGE	LUMENS	OUTER DIA. (MM)
LPR-71403-SL	3 W	210	85
LPR-71406-SL	6 W	420	120
LPR-71412-SL	12 W	960	174
LPR-71418-SL	18 W	1530	225

SPECIFICATIONS

CCT	2700K/4000K/6500K
CRI	>80
Power Factor	>0.95
Input Voltage	110 - 290V
Ingress Protection	IP 20
Operating Temp.	-10°C to 55°C
Working Life	40000 Hours
Beam Angle	120°
Housing	Aluminium Diecast
Diffuser	Polycarbonate



APPLICATIONS

Offices • Conference Rooms • Homes
• Hallways • Galleries • Shopping Malls
• Hotels



SLIM PANEL : STERRA - SL SQUARE			
MODEL NO.	WATTAGE	LUMENS	OUTER DIA. (MM)
LPS-71403-SL	3 W	210	85 X 85
LPS-71406-SL	6 W	420	120 X 120
LPS-71412-SL	12 W	960	174 X 174
LPS-71418-SL	18 W	1530	225 X 225



Eco
Friendly



Save
Energy



Instant
Start



No UV/IR



No Mercury
Hazard



Non
Dimmable



SURFACE PANEL : STERRA - CM ROUND

MODEL NO.	WATTAGE	LUMENS	OUTER DIA. (MM)
LPR-91406	6 W	420	120
LPR-91412	12 W	960	174
LPR-91418	18 W	1530	225

SPECIFICATIONS

CCT	2700K/4000K/6500K
CRI	> 80
Power Factor	> 0.95
Input Voltage	110 - 290V
Ingress Protection	IP 20
Operating Temp.	-10°C to 55°C
Working Life	40000 Hours
Beam Angle	120°
Housing	Aluminium Diecast
Diffuser	Polycarbonate



APPLICATIONS

Offices • Conference Rooms • Homes •
Hallways • Galleries • Shopping Malls •
Workstations



SURFACE PANEL : STERRA - CM SQUARE

MODEL NO.	WATTAGE	LUMENS	OUTER DIA. (MM)
LPS-91406	6 W	420	120 X 120
LPS-91412	12 W	960	174 X 174
LPS-91418	18 W	1530	225 X 225



Eco
Friendly



Save
Energy



Instant
Start



No UV/IR



No Mercury
Hazard



Non
Dimmable



DOME LIGHT : ASTRA - P

MODEL NO.	WATTAGE	LUMENS	OUTER DIA. (MM)
LPR-21706	6 W	540	85
LPR-21709	9 W	810	85

SPECIFICATIONS

CCT	2700K/4000K/6500K
CRI	>80
Power Factor	>0.95
Input Voltage	110 - 290V
Ingress Protection	IP 20
Operating Temp.	-10°C to 55°C
Rated Life	50000 Hours
Beam Angle	120°
Housing	PVC/ Thermoplastic (Luminaire Grade)
Diffuser	Polycarbonate



APPLICATIONS

Showroom • Malls • Houses • Offices
• Hospitals • Hotels • Restaurants



LED PANEL : LUCIA - P

MODEL NO.	WATTAGE	LUMENS	OUTER DIA. (MM)
LPR-21705	5 W	450	85
LPR-21710	10 W	900	109
LPR-21715	15 W	1350	133
LPR-21720	20 W	1800	160



Eco
Friendly



Save
Energy



Instant
Start



No UV/IR



No Mercury
Hazard



Non
Dimmable



PANEL 2' X 2'

MODEL NO.	WATTAGE	LUMENS	SIZE (MM)
LPS-2236	36 W	3240	600 x 600
LPS-2240	40 W	3600	600 x 600

PANEL 1' X 1'

LPS-1118	18 W	1620	300 x 300
LPS- 1120	20 W	1800	300 x 300

SPECIFICATIONS

CCT	2700K/4000K/6500K
CRI	>80
Power Factor	>0.95
Input Voltage	110 - 290V
Ingress Protection	IP 20
Operating Temp.	-10°C to 55°C
Rated Life	50000 Hours
Beam Angle	120°
Housing	CRCA Mild Steel
Diffuser	Polycarbonate



APPLICATIONS

Offices • Conference Rooms • Homes •
Work Tables • Hallways • Galleries •
Shopping Malls • Workstations



SLIM PANEL 2' X 2'

MODEL NO.	WATTAGE	LUMENS	SIZE (MM)
LPS-2236-S	36 W	3240	600 X 600
LPS-2240-S	40 W	3600	600 X 600

SLIM PANEL 1' X 1'

LPS-1118-S	18 W	1620	300 x 300
LPS-1120-S	20 W	1800	300 x 300

SPECIFICATIONS

CCT	2700K/4000K/6500K
CRI	>80
Power Factor	>0.95
Input Voltage	110 - 290V
Ingress Protection	IP 20
Operating Temp.	-10°C to 55°C
Rated Life	50000 Hours
Beam Angle	120°
Housing	Aluminium Extruded
Diffuser	Polycarbonate



APPLICATIONS

Offices • Conference Rooms • Homes •
Work Tables • Hallways • Galleries •
Shopping Malls • Workstations



Eco
Friendly



Save
Energy



Instant
Start



No UV/IR



No Mercury
Hazard



Non
Dimmable



SLIM PANEL - 2' X 1'

MODEL NO.	WATTAGE	LUMENS	SIZE (MM)
LPS-2124	24 W	2160	600 X 300

SLIM PANEL - 4' X 1'

LPS-4136	36 W	3240	1200 X 300
----------	------	------	------------

SPECIFICATIONS

CCT	2700K/4000K/6500K
CRI	> 80
Power Factor	> 0.95
Input Voltage	110 - 290V
Ingress Protection	IP 20
Operating Temp.	-10°C to 55°C
Rated Life	50000 Hours
Beam Angle	120°
Housing	Aluminium Extruded
Diffuser	Polycarbonate



APPLICATIONS

Offices • Conference Rooms • Hallways
• Galleries • Shopping Malls



LED CLEAN ROOM PANEL LIGHT

MODEL NO.	WATTAGE	LUMENS	SIZE (MM)
LCPL-1718	18 W	1800	295 X 295 x 60
LCPL-1730	30 W	3000	595 X 295 x 60
LCPL-1740	40 W	4000	595 X 595 x 60
LCPL-1760	60 W	6000	595 X 595 x 60

SPECIFICATIONS

CCT	2700K/4000K/6500K
CRI	>80
Power Factor	>0.95
Input Voltage	110 - 290V
Ingress Protection	IP 20
Operating Temp.	-10°C to 55°C
Rated Life	50000 Hours
Beam Angle	120°
Housing	CRCA Mild Steel
	Aluminium Extruded
Diffuser	Polycarbonate



APPLICATIONS

Laboratories • Food Industries •
Sanitized Places • Hospitals • Pharma
Industries



Eco
Friendly



Save
Energy



Instant
Start



No UV/IR



No Mercury
Hazard



Non
Dimmable



COB SPOT LIGHT : CENTRA

MODEL NO.	WATTAGE	LUMENS	OUTER DIA. (MM)
LSP-21706	6 W	540	85
LSP-21709	9 W	810	85
LSP-21712	12 W	1080	109
LSP-21716	16 W	1440	109
LSP-21724	24 W	2160	133
LSP-21730	30 W	2700	160

SPECIFICATIONS

CCT	2700K/4000K/6500K
CRI	>80
Power Factor	>0.95
Input Voltage	110 - 290V
Ingress Protection	IP 20
Operating Temp.	-10°C to 55°C
Rated Life	50000 Hours
Beam Angle	20° - 60°
Housing	Aluminium Diecast
Diffuser	Clear Glass
Light Distribution	Narrow / Medium
Tilt	Adjustable / Fixed



APPLICATIONS

Theater • Showrooms • Malls • Houses



Eco Friendly



Save Energy



Instant Start



No UV/IR



No Mercury Hazard



Non Dimmable



MR 16		
MODEL NO.	WATTAGE	LUMENS
LMR-1603	3 W	270
LMR-1605	5 W	450
LMR-1607	7 W	630
LMR-1609	9 W	810

SPECIFICATIONS

CCT	2700K/4000K/6500K
CRI	> 80
Power Factor	> 0.95
Input Voltage	110 - 290V
Ingress Protection	IP 20
Operating Temp.	-10°C to 55°C
Rated Life	50000 Hours
Beam Angle	20° - 90°
Housing	Aluminium Diecast
Diffuser	Clear Glass
Light Distribution	Narrow / Medium / Large
Base	GU5.3 / GU10
Tilt	Adjustable / Fixed



APPLICATIONS

Showrooms • Architecture Lighting •
Facade Lighting • Spot Lighting



Eco
Friendly



Save
Energy



Instant
Start



No UV/IR



No Mercury
Hazard



Non
Dimmable



LED T5 TUBE LIGHT BATTENS : GALAXY

MODEL NO.	WATTAGE	LENGHT (MM)	LUMENS
LTL-081509	9 W	580	900
LTL-081518	18 W	1160	1800
LTL-081522	22 W	1160	2200

LED T8 TUBE LIGHT BATTENS : GALAXY

LTL-081709	9 W	580	900
LTL-081718	18 W	1160	1800
LTL-081722	22 W	1160	2200
LTL-081740	40 W	1160	4000

SPECIFICATIONS

CCT	2700K/4000K/6500K
CRI	>80
Power Factor	>0.95
Input Voltage	110 - 290V
Ingress Protection	IP 20
Operating Temp.	-10°C to 55°C
Rated Life	50000 Hours
Beam Angle	>120°
Housing	Aluminium Extruded Thermoplastic (Luminaire Grade)
Diffuser	Polycarbonate



APPLICATIONS

Offices • Conference Rooms • Homes •
Work Tables • Parking Areas • Malls



Eco
Friendly



Save
Energy



Instant
Start



No UV/IR



No Mercury
Hazard



Non
Dimmable



TUBE LIGHT : T8 RETROFIT

MODEL NO.	WATTAGE	LENGHT (MM)	LUMENS
LT8-1709	9 W	580	900
LT8-1718	18 W	1160	1800
LT8-1722	22 W	1160	2200

TUBE LIGHT : T5 RETROFIT

LT5-1709	9 W	580	900
LT5-1718	18 W	1160	1800
LT5-1722	22 W	1160	2200

SPECIFICATIONS

CCT	2700K/4000K/6500K
CRI	>80
Power Factor	>0.95
Input Voltage	110 - 290V
Ingress Protection	IP 20
Operating Temp.	-10°C to 55°C
Rated Life	50000 Hours
Beam Angle	>120°
Housing	Aluminium Extruded
	Thermoplastic
Diffuser	Polycarbonate
Fixture Available	Box Type Fitting
	Mirror Optic Fitting



APPLICATIONS

Schools • Offices • Conference Rooms
• Malls • Homes • Work Tables •
Parking Areas



Eco
Friendly



Save
Energy



Instant
Start



No UV/IR



No Mercury
Hazard



Non
Dimmable



LINEAR LIGHT

MODEL NO.	WATTAGE	LUMENS	DIMENSION (MM)
LLT-21710	10 W	1000	300 X 52 X 66
LLT-21720	20 W	2000	600 X 120 X 70
LLT-21730	30 W	3000	1200 X 120 X 70
LLT-21740	40 W	4000	1200 X 120 X 70
LLT-21740	40 W	4000	2400 X 120 X 70
LLT-21780	80 W	8000	2400 X 120 X 70

SPECIFICATIONS

CCT	2700K/4000K/6500K
CRI	>80
Power Factor	>0.95
Input Voltage	110 - 290V
Ingress Protection	IP 20
Operating Temp.	-10°C to 55°C
Rated Life	50000 Hours
Beam Angle	140°
Housing	Aluminium Extruded
Mounting	Recessed / Surface / Suspended
* 36 & 48 W also available in CRCA steel housing	
* Up & Down light model also available	



APPLICATIONS

Schools • Offices • Conference Rooms •
Malls • Homes • Work Tables • Parking
Areas



Eco
Friendly



Save
Energy



Instant
Start



No UV/IR



No Mercury
Hazard



Non
Dimmable



WEATHERPROOF BATTENS

MODEL NO.	WATTAGE	LUMENS	DIMENSION (MM)
LWT-21718	18 W	1800	1180 X 86 X 66
LWT-21720	20 W	2000	1180 X 86 X 66
LWT-21730	30 W	3000	1180 X 86 X 66
LWT-21736	36 W	3600	1180 X 86 X 66
LWT-21740	40 W	4000	1180 X 86 X 66
LWT-217118	1 x 18 W	1800	1180 X 86 X 66
LWT-217218	2 x 18 W	3600	1180 X 86 X 66

SPECIFICATIONS

CCT	2700K/4000K/6500K
CRI	>80
Power Factor	>0.95
Input Voltage	110 - 290V
Ingress Protection	IP 66
Operating Temp.	-10°C to 55°C
Rated Life	50000 Hours
Beam Angle	140°
Body	Polycarbonate
Diffuser	Polycarbonate
Base Tray	Aluminium Extruded
* Complete LED Fixture (Non - Retrofit)	
* Available with Retrofit LED Tubes	



APPLICATIONS

Parking Areas • Utility Shades • Industries
• Weatherproof Locations • Malls • Homes
• Schools • Hospitals • Warehouses



Eco
Friendly



Save
Energy



Instant
Start



No UV/IR



No Mercury
Hazard



Non
Dimmable



RETROFIT LAMPS - PL (4 Pin) : PRAGMA

MODEL NO.	WATTAGE	LUMENS	TO REPLACE CFL LAMP OF	LENGTH (MM)	BASE
LRL-1706-G11	6 W	540	11 W	227	2G11 (4 - Pin)
LRL-1709-G11	9 W	810	18 W	227	2G11 (4 - Pin)
LRL-1708-G11	18 W	1620	36 W	410	2G11 (4 - Pin)

SPECIFICATIONS

CCT	2700K/4000K/6500K
CRI	>80
Power Factor	>0.95
Input Voltage	110 - 290V
Ingress Protection	IP 20
Operating Temp.	-10°C to 55°C
Rated Life	50000 Hours
Beam Angle	120°
Housing	Aluminium Extruded
Diffuser	Polycarbonate



APPLICATIONS

Showrooms • Malls • Houses • Offices
• Hospitals • Hotels • Restaurants • Rural
Areas

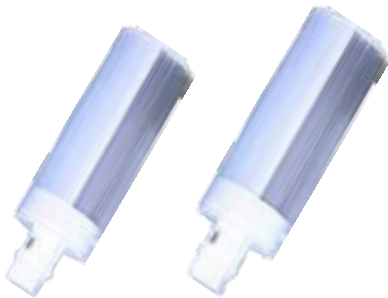

RETROFIT LAMPS - G 24 : PRAGMA

MODEL NO.	WATTAGE	LUMENS	TO REPLACE CFL LAMP OF	LENGTH (MM)	BASE
LRL-1706-G24	6 W	540	11 W	80	G - 24
LRL-1708-G24	8 W	720	15 W	97	G - 24
LRL-1709-G24	9 W	810	18 W	113	G - 24
LRL-1712-G24	12 W	1080	26 W	130	G - 24
LRL-1718-G24	18 W	1620	36 W	150	G - 24



Eco
Friendly



Save
Energy



Instant
Start



No UV/IR



No Mercury
Hazard



Non
Dimmable

At present, street lighting makes use of high-intensity discharge lamps, often high pressure sodium lamps (HPS). Such lamps provide the great amount of photopic illumination for the least consumption of electricity. However, when scotopic / photopic light calculations are considered, it is evident how inappropriate HPS lamps are for night lighting as traditional white light sources have been shown to double driver peripheral vision and increase driver brake reaction time by at least 25% which is a cause of concern.

New street lighting technologies, such as LED lights, emit a white light that provides high levels of scotopic lumens making street lights with lower wattage and lower photopic lumens viable options existing street lights.

General Benefits of LED Street Lights :

LESS ENERGY CONSUMPTION

LED street lights use 40-80% less electricity and have at least 5 times the life expectancy than regular high pressure sodium (HPS) fixtures. LED lamps are seven times more energy efficient than incandescent and twice as efficient as fluorescent (CFL) lights.

EFFICIENT AND LOW LIGHT POLLUTION : DIRECTIONALITY

LED street lights with a lower lumen output for example, a 30W LED street light can replace conventional lamps with the higher output like an 80W High Pressure Sodium lamp owing to LEDs being highly directional. Directionality of LED street lamps leads to better light output in comparison to other types of lamps. As there is little, or no hotspot under the LED lamp and the light emitted from it is directed downwards and is spread throughout the entire area it covers. This means less light is needed to properly illuminate the area. Lower amount of light is needed to properly illuminate the area. The use of LED street lights thus helps also drastically reduces light pollution, which positively impacts the mood of human beings, navigation in birds and insects, mating behavior in animals and flowering in plants.

LONG LIFE – UP TO 100,000 HOURS

LED street lights last much longer than conventional lamps (3 to 8 times longer) resulting in less expenditure in replacing the lights and reduced labor to replace the lamps. In addition to the reduced expense, the loss of brightness or lumen depreciation is slower over the life of an LED lamp than the of a sodium or other lamp; so, the LED stays bright longer than the others. The long life span reduces maintenance expenses and make LED bulbs particularly suitable for difficult to reach locations and for streetlights where maintenance costs can be a significant factor.

GREAT OPERATING CHARACTERISTICS

LEDs are fit to operate at lower temperatures, are not sensitive to low temperature and unaffected by “on” and “off” cycle.

This makes them safer, efficient in cold environments (outdoor lights, refrigerator lights and cold room lights) and better for applications requiring frequent switching “on” and “off” lights. LEDs are also are shocks and vibration resistant making them the best choice for places like bridges.

REDUCING CARBON FOOTPRINT

Reducing the carbon footprint of LED lights helps reduce carbon footprint thanks to the lower energy usage and its longer lifecycle.

DARK SKY FRIENDLY

Since LED lights provide light exactly where it’s supposed to be directed, there is next to no light wastage in illuminating the night sky. This is a visible benefit of LED lights specially if there is a Dark Sky Initiative I the local community.

NATURAL LIGHT SPECTER – COLOR RENDERING INDEX

LED street lamps with color temperature 3.500-4.200 K are rendering more natural light than the yellow of sodium lamps or green of flourescent streetlights. The color rendering Index (CRI) OF LEDs is high 80 -90 which helps displays natural colors of illuminated objects.

FREE OF HARMFUL SUBSTANCES AND LOWER ENVIRONMENTAL IMPACT WHEN USED UP

LED luminaires contain no harmful substances, like mercury, lead or hazardous chemical and gasses hence, spent LED lamps can be thrown away without any special disposal requirements, since they are recyclable and environment friendly. Other light often have hazardous materials such as lead and mercury which require proper disposal care and waste management procedures which have both economic and environmental costs.

EASILY CONTROLLABLE

LED lights can be moderated and controlled with intelligent systems allowing ease of use for setting like light saving at dawn dusk and also during hours of low traffic . Multiple times switching on and LED lights does not affected the lifetime of these lights.





STREET LIGHT

MODEL NO.	WATTAGE	LUMENS
LSL-15020	20 W	1800
LSL-15024	24 W	2160
LSL-15040	40 W	3600
LSL-15060	60 W	5400
LSL-15075	75 W	6750
LSL-15090	90 W	8100
LSL-15120	120 W	10800

CCT	2700K/4000K/6500K
CRI	>80
Power Factor	>0.95
Input Voltage	110 - 290V
Ingress Protection	IP 66
Operating Temp.	-10°C to 55°C
Rated Life	50000 Hours
Beam Angle	≥ 120°
Housing	Aluminum Diecast
Cover	Toughened Glass
Secondary Optics	With Lens / Without Lens
Surge Protection	5KV



APPLICATIONS

Street Lighting • Garden Lighting •
Campus Lighting • Road Lighting



DECO COB STREET LIGHT		
MODEL NO	WATTAGE	LUMENS
LSL-17030-F	30 W	2700
LSL-17050-F	50 W	4500
LSL-17080-F	80 W	7200
LSL-17100-F	100 W	9000



- 

Eco Friendly
- 

Save Energy
- 

Instant Start
- 

No UV/IR
- 

No Mercury Hazard
- 

Non Dimmable



POWER LED FLOOD LIGHT		
MODEL NO.	WATTAGE	LUMENS
LFL-15030	30 W	2700
LFL-15050	50 W	4500
LFL-15070	70 W	6300
LFL-15100	100 W	9000
LFL-15120	120 W	10800
LFL-15150	150 W	13500
LFL-15200	200 W	18000
LFL-15300	300 W	27000

SPECIFICATIONS	
CCT	2700K/4000K/6500K
CRI	>80
Power Factor	>0.95
Input Voltage	110 - 290V
Ingress Protection	IP 66
Operating Temp.	-10°C to 55°C
Rated Life	50000 Hours
Beam Angle	≥ 120°
Housing	Aluminum Diecast
Cover	Toughened Glass
Secondary Optics	With Lens / Without Lens
Surge Protection	5KV



APPLICATIONS

Showrooms • Malls • Area Lighting •
Hoarding • Display Boards • Facade
Lighting



Eco
Friendly



Save
Energy



Instant
Start



No UV/IR



No Mercury
Hazard



Non
Dimmable



HIGH BAY LIGHT		
MODEL NO.	WATTAGE	LUMENS
LBL-15030	30 W	2700
LBL-15050	50 W	4500
LBL-15070	70 W	6300
LBL-15100	100 W	9000
LBL-15150	150 W	13500
LBL-15200	200 W	18000

SPECIFICATIONS

CCT	2700K/4000K/6500K
CRI	>80
Power Factor	>0.95
Input Voltage	110 - 290V
Ingress Protection	IP 20
Operating Temp.	-10°C to 55°C
Rated Life	50000 Hours
Beam Angle	≥120°
Housing	Aluminum Diecast
Cover	Toughened Glass
Secondary Optics	With Lens / Without Lens
Surge Protection	5KV
* Other sleek designs also available	



APPLICATIONS

Industrial Sheds • Factories • Workshops
• Malls • Atriums



Eco
Friendly



Save
Energy



Instant
Start



No UV/IR



No Mercury
Hazard



Non
Dimmable



STRIP LIGHT

MODEL NO.	WATTAGE	LENGTH (MM)	AVAILABLE IN
LST-05	5 W	1000	5 METER ROLL
LST-10	10 W	1000	5 METER ROLL
LST-15	15 W	1000	5 METER ROLL
LST-20	20 W	1000	5 METER ROLL

SPECIFICATIONS

CCT	2700K/4000K/6500K/Red/ Green/Blue/RGB
Ingress Protection	IP20/IP65 (Normal / Water Proof)
Operating Temp.	-10°C to 55°C
Rated Life	50000 Hours
Also available with aluminium channel	



APPLICATIONS

Showrooms • Malls • Houses • Offices
• Hotels • Hospitals • Restaurants



LED STRIP DRIVER

MODEL NO	CURRENT	DIMENSION (MM)
LSD-2	2 AMP	110 X 53 X 40
LSD-3	3 AMP	120 X 55 X 40
LSD-5	5 AMP	170 X 55 X 40
LSD-10	10 AMP	120 X 55 X 40
LSD-15	15 AMP	170 X 55 X 40



Eco
Friendly



Save
Energy



Instant
Start



No UV/IR



No Mercury
Hazard



Non
Dimmable



SPIKE LIGHT

MODEL NO.	WATTAGE	LUMENS
LGL-1706	6W	540
LGL-1709	9W	810
LGL-17012	12W	1080

SPECIFICATIONS

CCT	2700K/4000K/6500K
CRI	>80
Power Factor	>0.95
Input Voltage	110 - 290V
Ingress Protection	IP 66
Operating Temp.	-10°C to 55°C
Rated Life	40000 Hours
Beam Angle	120
Housing	Aluminum Diecast
Cover	Toughened Glass



APPLICATIONS

Parks • Gardens • Showroom • Malls •
Hotels • Restaurants • Landscapes •
Campuses • Resorts



Eco
Friendly



Save
Energy



Instant
Start



No UV/IR



No Mercury
Hazard



Non
Dimmable



WELL GLASS LIGHT

MODEL NO.	WATTAGE	LUMENS
LWG-1718	18W	1800
LWG-1742	42W	4200

SPECIFICATIONS

CCT	2700K/4000K/6500K
CRI	>80
Power Factor	>0.95
Input Voltage	110 - 290V
Ingress Protection	IP 66
Operating Temp.	-10°C to 55°C
Rated Life	50000 Hours
Beam Angle	≥120
Housing	Aluminum Diecast
Diffuser	Polycarbonate



APPLICATIONS

Factories • Farmhouses • Gardens •
Malls • Showroom • Industrial Outdoors



Eco
Friendly



Save
Energy



Instant
Start



No UV/IR



No Mercury
Hazard



Non
Dimmable



BOLLARD LIGHT

MODEL NO.	WATTAGE	LUMENS
LBL-8006	6 W	480
LBL-8009	9 W	750
LBL-8012	12 W	1000

SPECIFICATIONS

CCT	3000K/4000K/6500K
CRI	> 80
Power Factor	> 0.9
Input Voltage	110 - 290V
Ingress Protection	IP 66
Operating Temp.	-10°C to 55°C
Rated Life	50000 Hours
Beam Angle	120
Housing	Aluminum Diecast
Diffuser	Polycarbonate



APPLICATIONS

Parks • Gardens • Showrooms • Malls
• Hotels • Restaurants • Resorts •
Pathways



Eco
Friendly



Save
Energy



Instant
Start



No UV/IR



No Mercury
Hazard



Non
Dimmable



LED UP / DOWN WALL LIGHT

MODEL NO.	WATTAGE	LUMENS
LWL-1715-R	15 W	1500
LWL-1715-S	15 W	1500

SPECIFICATIONS

CCT	3000K/4000K/6500K
CRI	>80
Power Factor	>0.9
Input Voltage	110 - 290V
Ingress Protection	IP 20 / IP 66
Operating Temp.	-10°C to 55°C
Rated Life	50000 Hours
Beam Angle	40° / 60° / 100°
Housing	Aluminum Diecast
Cover	Toughened Glass Polycarbonate
Design	Round /Square



APPLICATIONS

Parks • Gardens • Showrooms • Malls
• Hotels • Restaurants • Columns •



Eco
Friendly



Save
Energy



Instant
Start



No UV/IR



No Mercury
Hazard



Non
Dimmable

WHAT IS AN 'CFL' ?

A compact fluorescent lamp (CFL), also called compact fluorescent light, energy-saving light, and compact fluorescent tube, is a fluorescent lamp designed to replace an incandescent light bulb; some types fit into light fixtures designed for incandescent bulbs. The lamps use a tube which is curved or folded to fit into the space of an incandescent bulb, and a compact electronic ballast in the base of the lamp.

TYPES OF 'CFL' LIGHTS

INTEGRATED LAMPS

Integrated lamps combine the tube and ballast in a single unit. These lamps allow consumers to replace incandescent lamps easily with CFLs. Integrated CFLs work well in many standard incandescent light fixtures, reducing the cost of converting to fluorescent. 3-way lamps and dimmable models with standard bases are available.

NON - INTEGRATED LAMPS

Non-integrated CFLs have the ballast permanently installed in the luminaire, and usually only the fluorescent tube is changed at its end of life. Since the ballasts are placed in the light fixture, they are larger and last longer compared to the integrated ones, and they don't need to be replaced when the tube reaches its end-of-life. Non-integrated CFL housings can be both more expensive and sophisticated.

They have two types of tubes: a bi-pin tube designed for conventional ballast, and a quad-pin tube designed for an electronic ballast or a conventional ballast with an external starter. A bi-pin tube contains an integrated starter, which obviates the need for external heating pins but causes incompatibility with electronic ballasts. Non-integrated CFLs can also be installed in a conventional light fixture using an adapter containing a built-in magnetic ballast. The adapter consists of a regular bulb screw, the ballast itself and a clip for the lamp's connector.

BENEFITS OF 'CFL' LIGHTS

- Save Energy
- Save Money
- Save the Environment
- Get More Light





USE AND ADOPTION OF 'CFL' LIGHTS

CFLs are produced for both alternating current (AC) and direct current (DC) input. DC CFLs are popular for use in recreational vehicles and off-the-grid housing. There are various aid agency initiatives in developing countries to replace kerosene lamps, which have associated health and safety hazards, with CFLs powered by batteries, solar panels or wind generators.

CFLs in solar powered street lights, use solar panels mounted on the pole.

Due to the potential to reduce electric consumption and pollution, various organizations have encouraged the adoption of CFLs and other efficient lighting. Efforts range from publicity to encourage awareness, to direct handouts of CFLs to the public. Some electric utilities and local governments have subsidized CFLs or provided them free to customers as a means of reducing electric demand (and so delaying additional investments in generation).





RETROFIT : 2U / 3U / 4U / 5U

MODEL NO	WATTAGE	DESCRIPTION	PACKAGING (BOX/CARTON)
RCB-2U05	5W	CFL 5W 2U 6500K	12/48
RWB-2U05	5W	CFL 5W 2U 2700K	12/48
RCB-3U08	8W	CFL 8W 3U 6500K	12/48
RWB-3U08	8W	CFL 8W 3U 2700K	12/48
RCB-2U09	9W	CFL 9W 2U 6500K	12/48
RCB-2U11	11W	CFL 11W 2U 6500K	12/48
RCB-2U15	15W	CFL 15W 3U 2700K	12/48
RWB-2U15	15W	CFL 15W 3U 6500K	12/48
RCB-3U20	20W	CFL 20W 3U 2700K	12/48
RWB-3U20	15W	CFL 23W 3U 6500K	12/48
RCB-3U23	23W	CFL 23W 3U 6500K	12/48
RCB-4U30	30W	CFL 30W 4U 6500K	12/48
RCB-4U36	36 W	CFL 36W 4U 6500K	12/48
RCB-4U45	45W	CFL 45W 4U 6500K	1/12
RCB-4U65	65W	CFL 65W 4U 6500K	1/12
RCB-4U85	85W	CFL 85W 4U 6500K	1/12
RCB-4U110	110W	CFL 110W 5U 6500K	1/12

SPIRALS

RCBS-009	9W	SPIRAL 9W 6500K	12/48
RCBS-015	15W	SPIRAL 15W 6500K	12/48
RCBS-020	20W	SPIRAL 20W 6500K	12/48
RCBS-023	23W	SPIRAL 23W 6500K	12/48
RCBS-027	27W	SPIRAL 27W 6500K	12/48
RCBS-030	30W	SPIRAL 30W 6500K	12/48
RCBS-036	36W	SPIRAL 36W 6500	12/48
RCBS-050	50W	SPIRAL 50W 6500	1/12
RCBS-070	70W	SPIRAL 70W 6500	1/12
RCBS-090	90W	SPIRAL 90W 6500	1/12



NON - RETROFIT			
MODEL NO	WATTAGE	DESCRIPTION	PACKAGING (BOX/CARTON)
NCG-1U09	9 W	PSL 9W 6500K	12/48
NCG-1U11	11 W	PSL 11W 6500K	12/48
NCG-2U10	10 W	PLD 10W 6500K	12/48
NCG-2U13	13 W	PLD 13W 6500K	48
NCG-2U18	18W	PLD 18W 6500K	48
NCG-1U18	18 W	PLD 18W 6500K	12/48
NCG-1U36	36 W	PLD 36W 6500K	12/48



APPLICATIONS

Schools • Showrooms • Offices • Malls
• Residential • Restaurants • Marts •
Galleries





Sample flat of Ashia





** Dimmable lights are also available on order.*

Disclaimer :

The products and specifications shown in this catalogue may vary slightly from the actual products and specifications due to our policy of continuous upgradation in design, quality and specifications.



Usha Shriram Enterprises Pvt. Ltd.

Block A, DDA Commercial Complex, Ring Road
Naraina, New Delhi - 110028. INDIA

Tel. : 011-45770990 , Toll Free No. : 1800 110 990

Email : sales@usha.in

website : www.usha.in

© Usha Shriram Enterprises Pvt. Ltd.

Bring Home Happiness